

LINTELS SHEET 1 - LAST REVISION 4/3/07

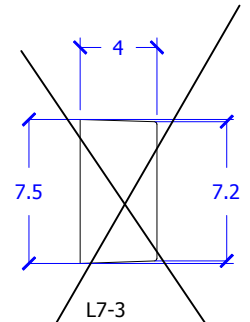

882 N. Marshall Way
 Layton, UT 84041
 Ph. (801) 544-9054
 Fax: (801) 544-9154

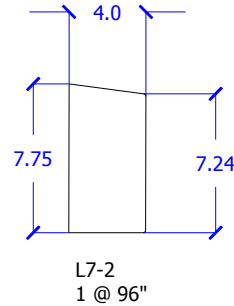
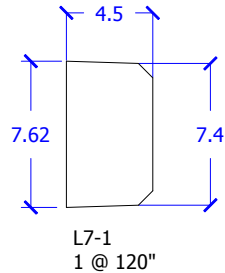
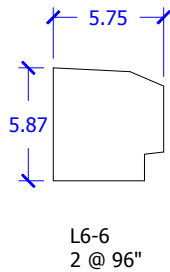
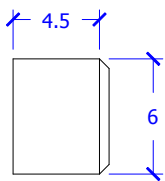
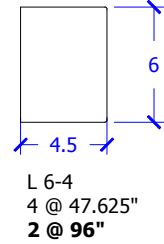
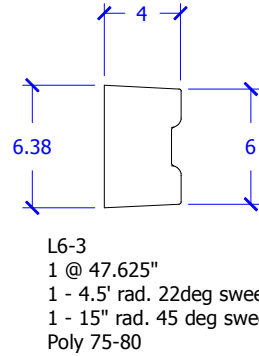
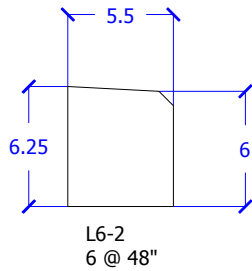
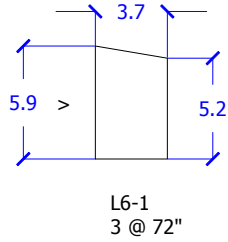
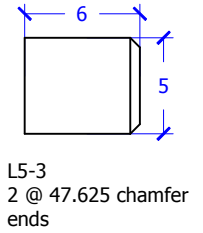
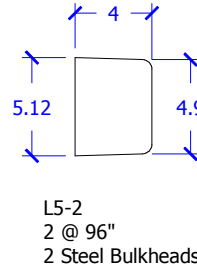
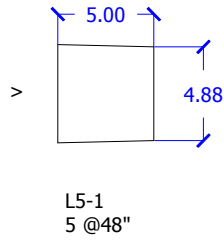
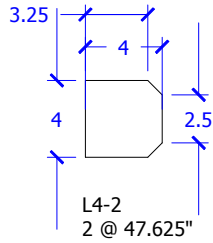
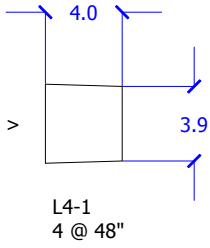

little known about this mold
 best to choose similar
L7-5 FOR INSTANCE

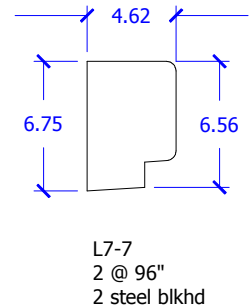
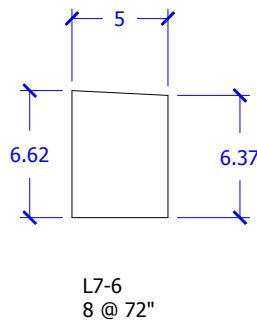
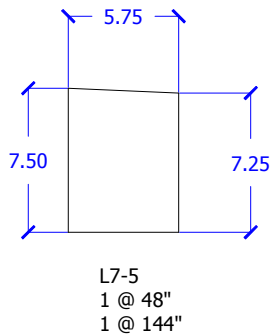
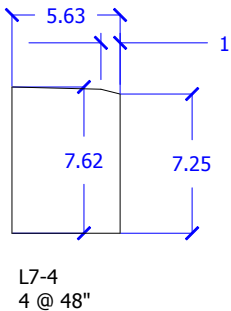

LINTELS SHEET 2 - LAST REVISION 4/3/07



882 N. Marshall Way
Layton, UT 84041
Ph. (801) 544-9054
Fax: (801) 544-9154

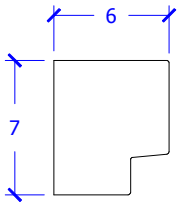

L7-8
1 @ 48"

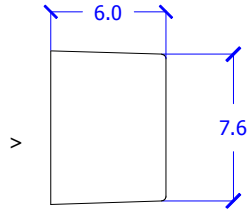

L8-1
8 @ 48"

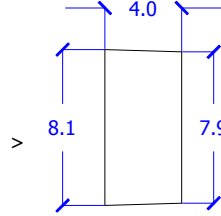

L8-2
2 @ 48"
1 @ 96"

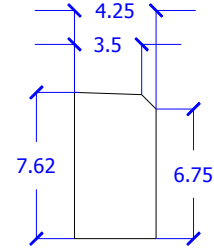

L8-3
1 @ 96"

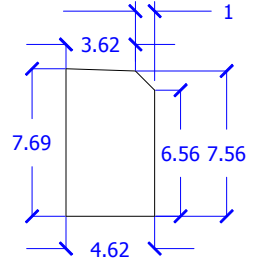

L8-4
2 @ 96"

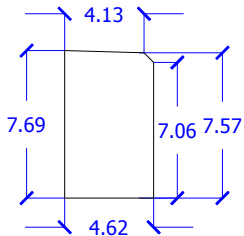

L8-5
3 @ 96
5 @ 48"

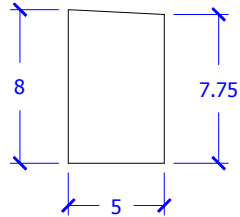

L8-6
2 @ 96"

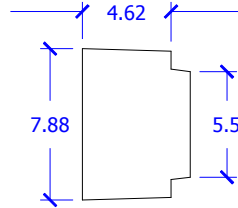

L8-7
1 @ 48"

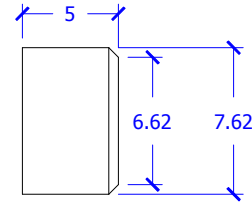

L8-8
2 @ 95.375" w/finends,
1 12" x 12" corner w/finends

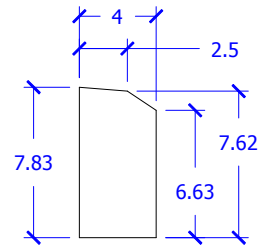

L8-9
2 @ 47.625"
1 leftfinend
1 rightfinend

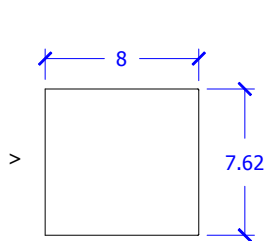

L8-10
2 @ 72"
2 @ 120"

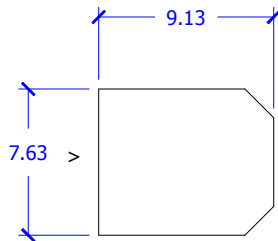

L8-11
2 @ 96"

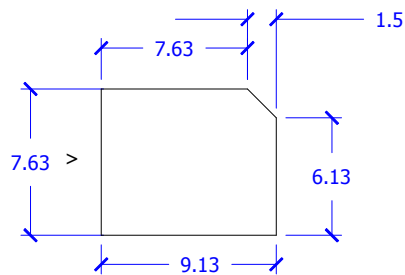

L8-12
2 @ 96"

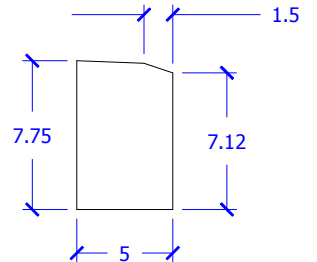

L8-13
1 @ 96"

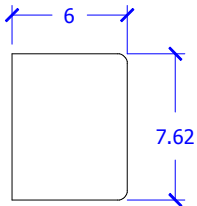

L8-14
2 @ 96"
2 steel blkhds

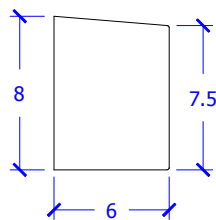

L8-15
3 @ 96"

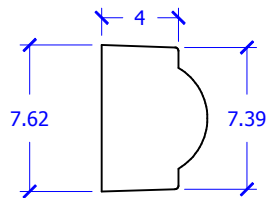

L8-16
6 at 48"
6 cornerformplates

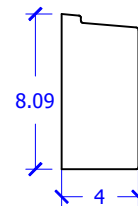

L8-17
3 at 96"

LINTELS SHEET 3 - LAST REVISION 4/3/07



882 N. Marshall Way
Layton, UT 84041
Ph. (801) 544-9054
Fax: (801) 544-9154

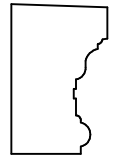

L8-18
Straights @ 48
inside corners 16x16
Country Club Villas

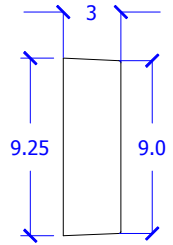

L9-1
4 @ 64"

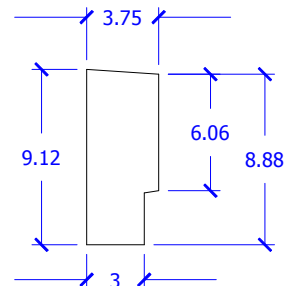

L9-2
3 @ 72"

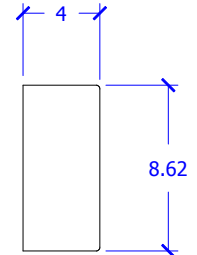

L9-3
4 @ 96"

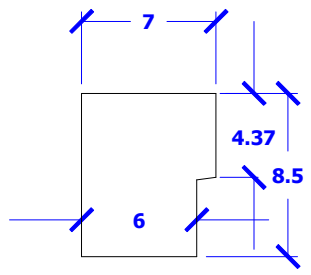

L9-4
1 @ 36"

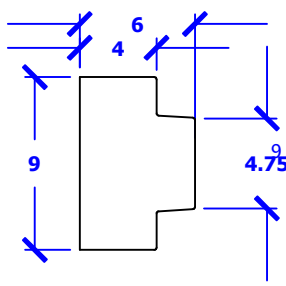

L9-5
1 @ 48"

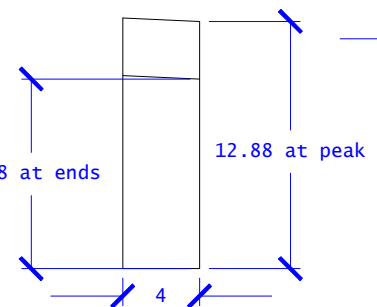

L10-1 Arch
1 @ 56"

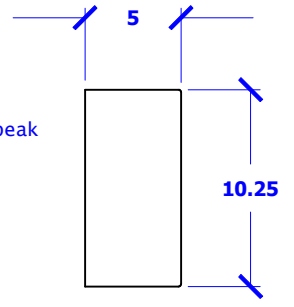

L10-2
5 @ 96.0
6 steel bulkheads

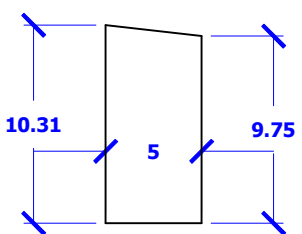

L10-3
2 @ 96"

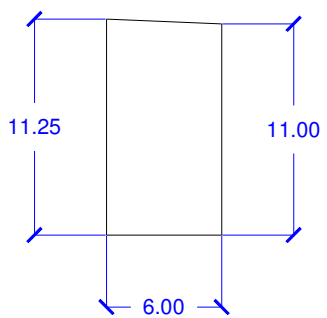

L11-1
1 @ 48"

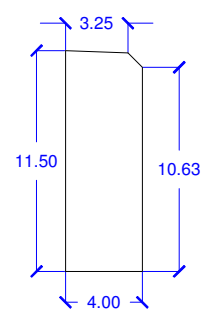

L11-2
3 @ 48"
5 @ 50 double finend

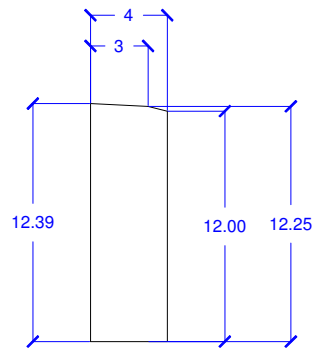

L12-1
2 @ 48"

LINTELS SHEET 4 - LAST REVISION 4/3/07



882 N. Marshall Way
 Layton, UT 84041
 Ph. (801) 544-9054
 Fax: (801) 544-9154

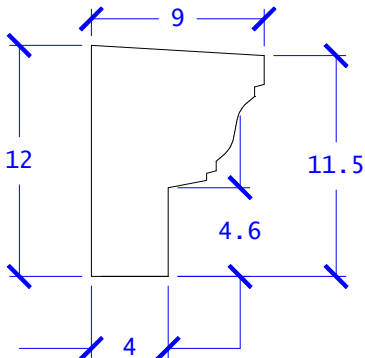

L12-2
 1@362finend
 1@48

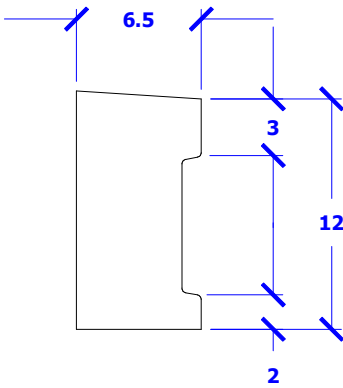
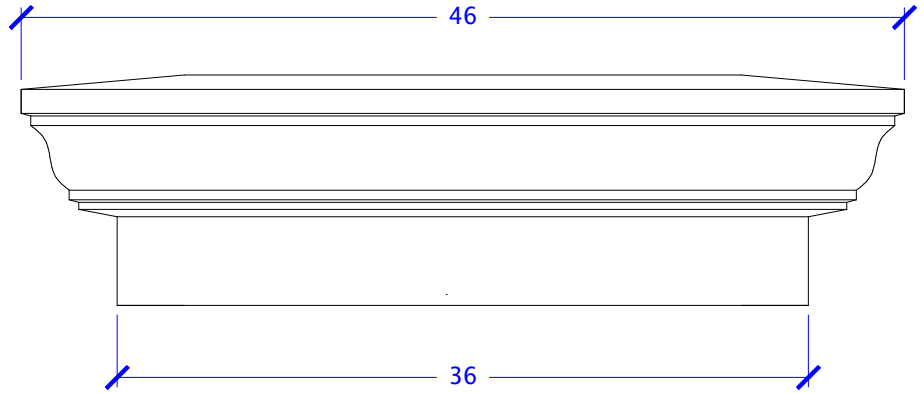

L12-3
 1 Straight @ 15.625, 1 curve 54 inrad w/22.5degree sweep
 1inrad 84

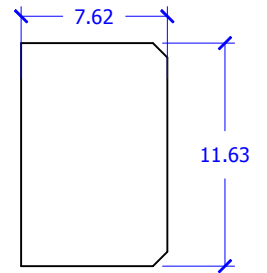
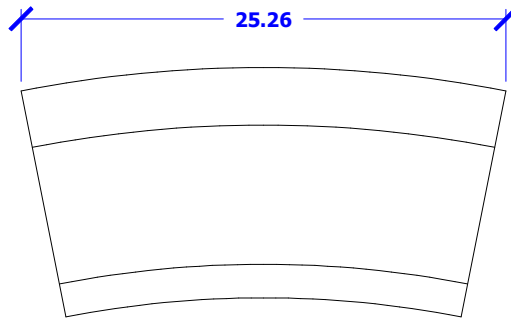

L12-4
 2 at 96 chamfer ends

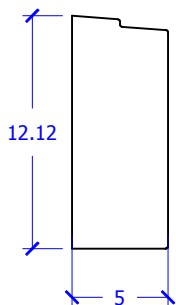

L12-5
 3 at 96"
 Monache

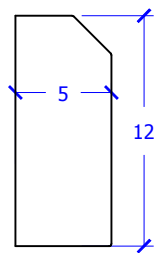

L12-6
 1left 1right 50.375 flat
 1left 1right 50.375 vert
 quarry bend

LINTELS SHEET 5 - LAST REVISION 1/2/07



882 N. Marshall Way
 Layton, UT 84041
 Ph. (801) 544-9054
 Fax: (801) 544-9154

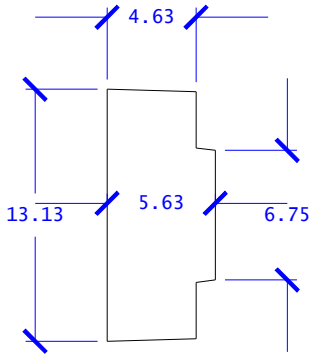

L13-1
1@48"

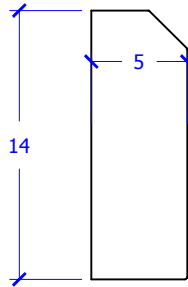

L14-1
 2 left 50.375
 2 right 50.375
 central district phase II

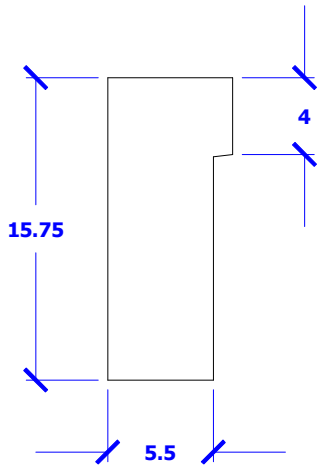

L16-2
2 at 96 chamfer ends

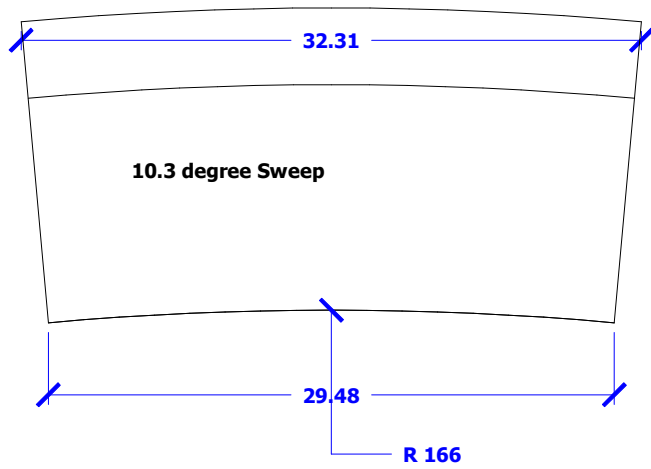

L16-1 Curved
1 mold
Ploytek 75-80

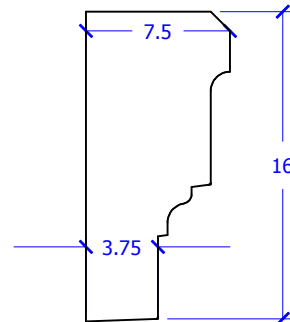
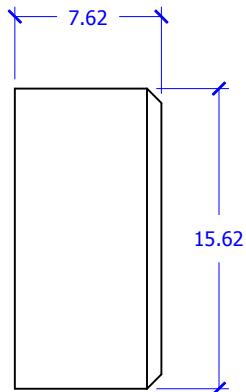

L16-3 1 steel at 96
 Primary Children's

LINTELS SHEET 6 - LAST REVISION 4/17/2007



882 N. Marshall Way
 Layton, UT 84041
 Ph. (801) 544-9054
 Fax: (801) 544-9154

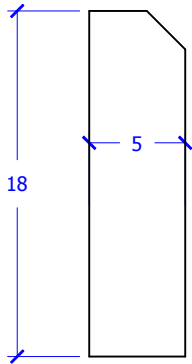

L18-1
 1left44
 1right44
 1 flatleft 44
 1 flatright44
 4heads
 Quarry Bend

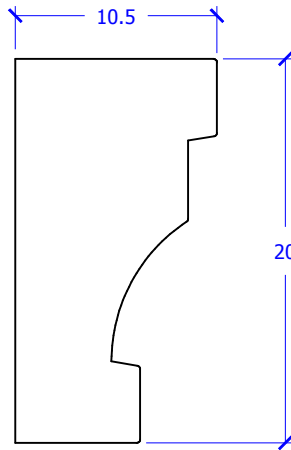

L20-1
 1 at 23.625

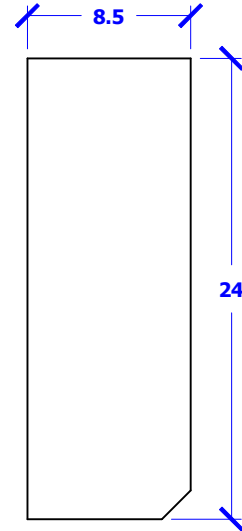

L24-1
 1 @ 48"

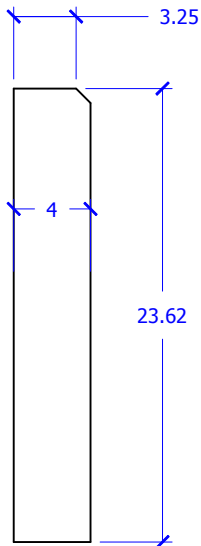

L24-2
 5 at 48" double corner
 2 at 48" Straight
 Lowe's Show Low Az

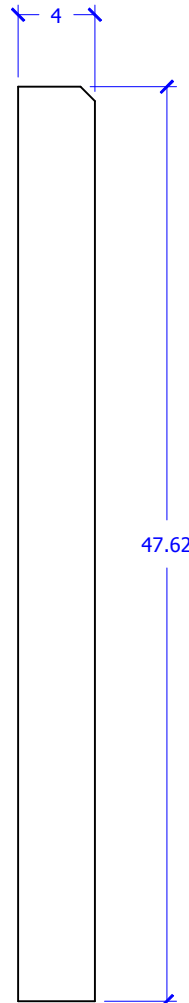

L48-1
 2 at 60 double corner
 1 at 60 Straight
 Lowe's Show Low Arizona