

SILLS SHEET 1 - LAST REVISION 4/21/07

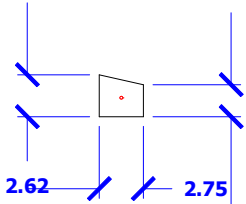

882 N. Marshall Way
Layton, UT 84041
Ph. (801) 544-9054
Fax: (801) 544-9154



S3-1
1@48

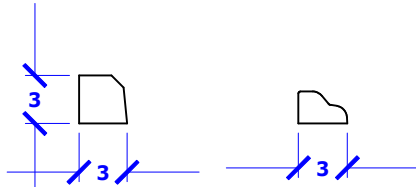

S3-2
2@48

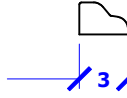

S3-3
3@48
1 51 left corner
carl's jr

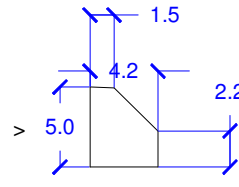

S4-1
2@72"
1 rightfin
1 leftfin
76.625

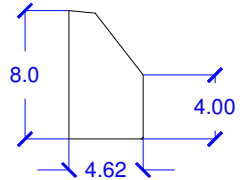

S4-2
3 @ 48"
1 @ 52.75 finend

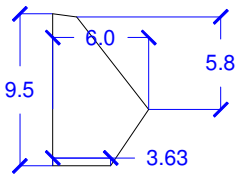

S4-3
4 @48"
1@54.25 finend

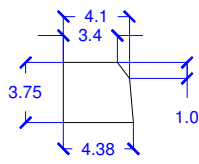

S4-4
1 @ 48"

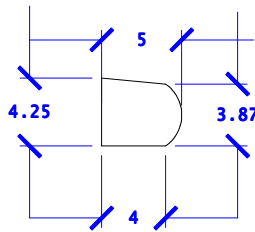

S4-5
7 @ 48

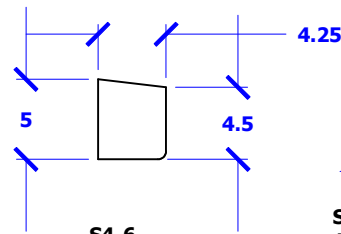

S4-6
2 @ 48

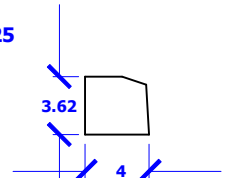

S4-7
1 double finend 51.385
Quarry Bend

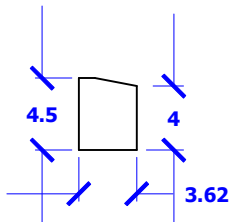

S4-8
5 at 48
Hamilton Retail

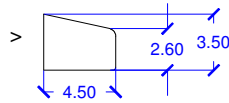

S5-1
2@60"

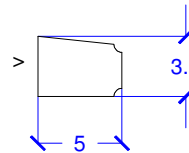

S5-2
Aprox 10 molds
@60"+corners
(fiberglass)

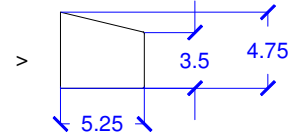

S5-3
1@48, 1@ 144
1 rightfin 77.625

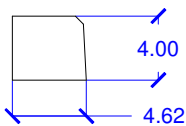

S5-4
1@48"

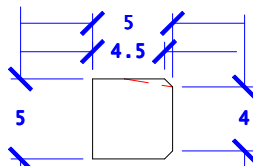

S5-5
1 @ 47.625

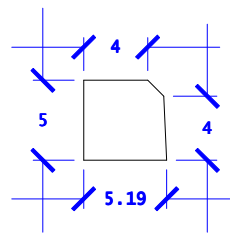

S5-6
2@ 47.625"
2 corners
24x24

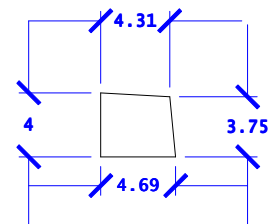

S5-7
1@ 47.625
1@72

SILLS SHEET 2 - LAST REVISION 4/21/07



882 N. Marshall Way
Layton, UT 84041
Ph. (801) 544-9054
Fax: (801) 544-9154

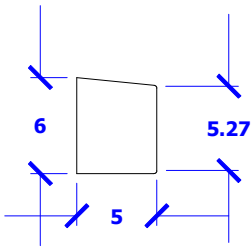

S5-8 2Ø72

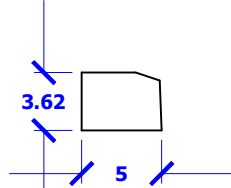

S5-9
1@96
2 doublecorner 51.25
bulkhead
centerville library

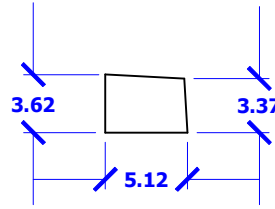

S5-10
1@96
1steelbulkhead

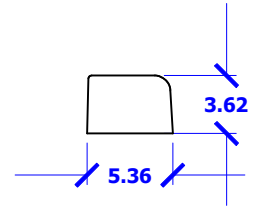

S5-11
5@50.5 double finend
5@48
Walgreens Gardnerville

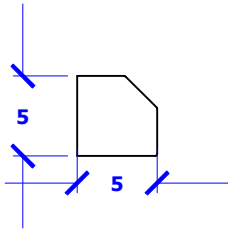

S5-12
2 53.375 right 2 ways
2 53.375 left 2 ways
quarry bend

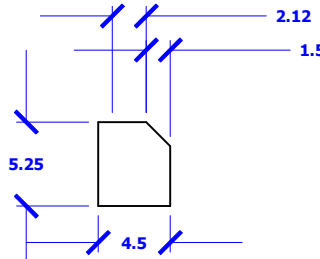

S5-13
2 left 61.75
2 right 61.75
central District

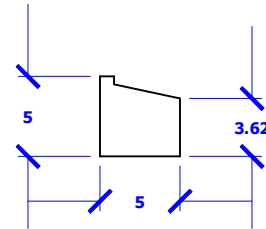

S5-14
3 at 96
W Jord Elem #4

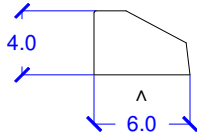

S6-3
1@60"
1corner(fbrgls) w/
finends (mezz)

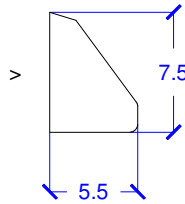

S6-1
4 @48"

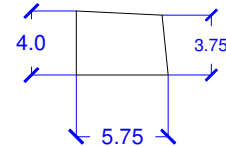

S6-2
4@48+ corner
+48 vertfinend
Taylorsville Senior
Center

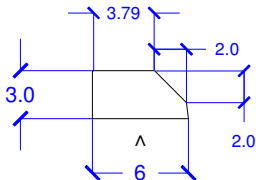

S6-4
3 @ 48

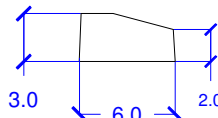

S6-5
2@64
1Ø60

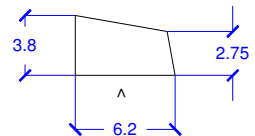

S6-6
5 @ 60
1 curve 15'inrad
(curvemold gfrp)

SILLS SHEET 2a - LAST REVISION 4/21/07



882 N. Marshall Way
Layton, UT 84041
Ph. (801) 544-9054
Fax: (801) 544-9154

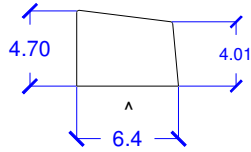

S6-7
12@48"
1incorn
1outcorn

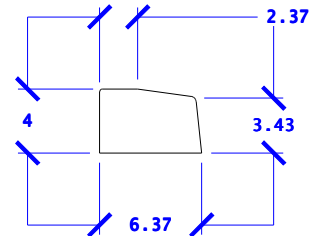

S6-8
2@48

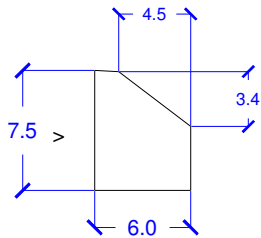

S6-9
1@79"
2@71"
8@47"
1@53"finend

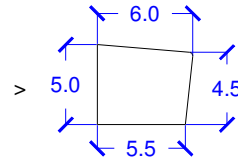

S6-10
4 @ 72"

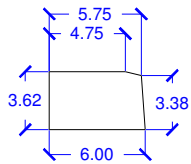

S6-11
12 @48"
2 outcorn 24x24

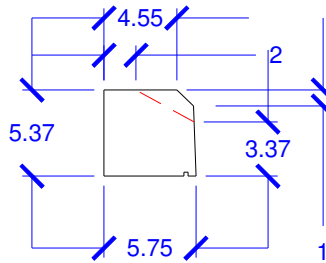

S6-12
2 @ 43.375
1 @ 71.375

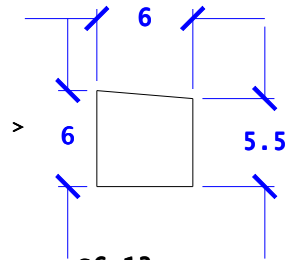

S6-13
2 @ 48"

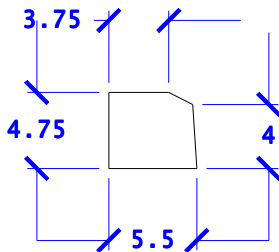

S6-14
1 @ 60

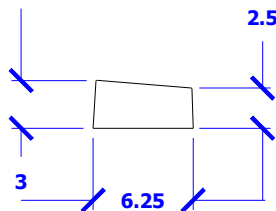

S6-15
2 @ 48

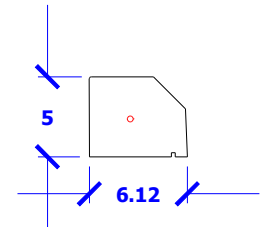

S6-16
4 @ 95.625
3left wrap 53
3 right wrap 53
3 corners when
5 tall
when 6" tall
6finendbulkheads

SILLS SHEET 3 - LAST REVISION 4/21/07



882 N. Marshall Way
Layton, UT 84041
Ph. (801) 544-9054
Fax: (801) 544-9154

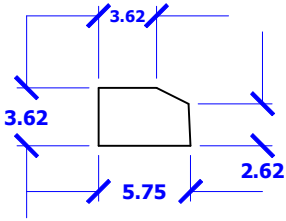

S6-17
8 @ 47.625

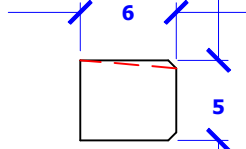

S6-18
1 at 64 lug ends
Cypress

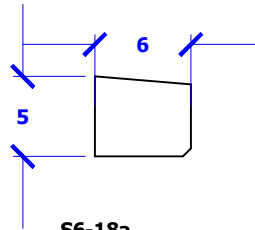

S6-18a
1 at 47.625
S6-18 compatible

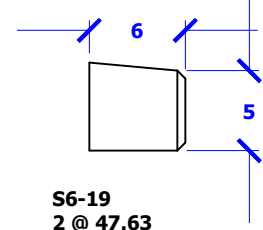

S6-19
2 @ 47.63
chamfer ends
Cypress
Riverton

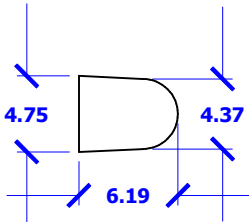

S6-20
1 rubber wood end
corner

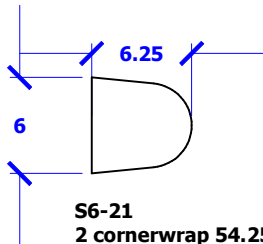

S6-21
2 cornerwrap 54.25
1 straight 48
Sandy Fire

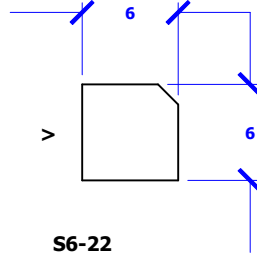

S6-22
1 right 74 1 left 74
Central District

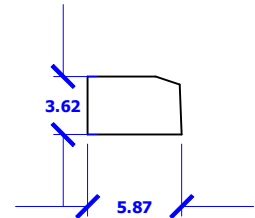

S6-23
1 at 96
Central District
store with S5-9

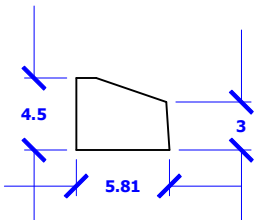

S6-24
3 at 96"
Clinton City

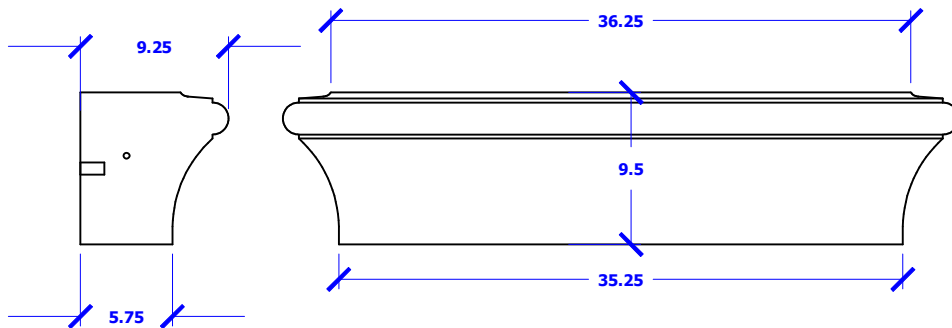

S6-25
2 molds
Country Club Villas Phase 2

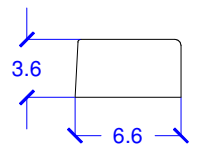

S7-1
1@47.625

SILLS SHEET 3a - LAST REVISION 4/21/07



882 N. Marshall Way
 Layton, UT 84041
 Ph. (801) 544-9054
 Fax: (801) 544-9154

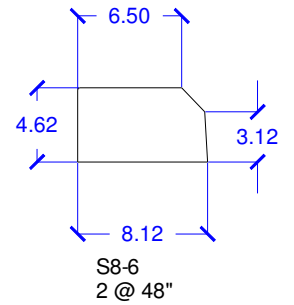
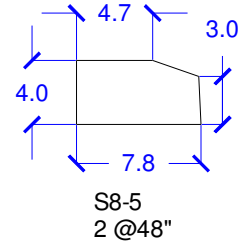
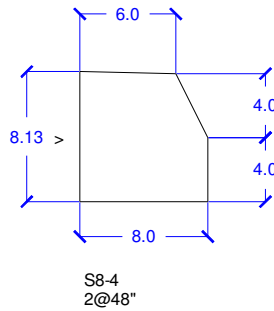
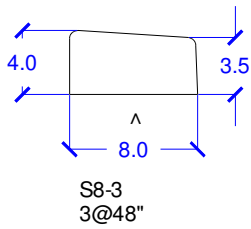
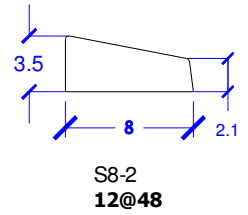
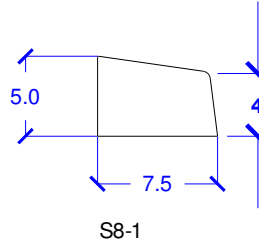
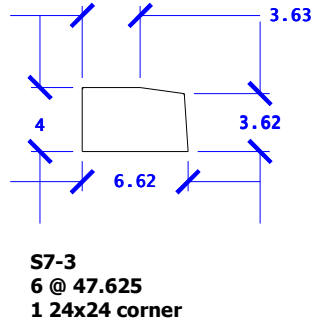
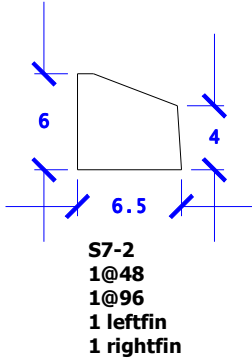

SILLS SHEET 4 - LAST REVISION 4/21/07



882 N. Marshall Way
Layton, UT 84041
Ph. (801) 544-9054
Fax: (801) 544-9154

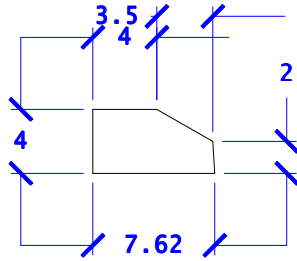

S8-7
1 @ 72"

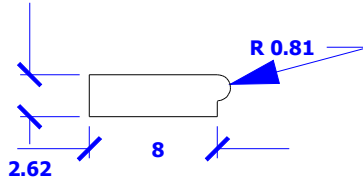

S8-8
1 @ 47.625

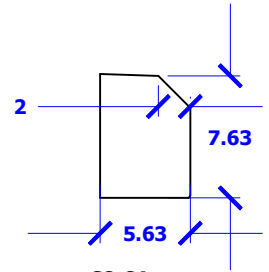

S8-8A
4 at 120
william penn

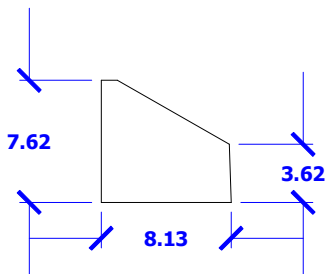

S8-9
2 @ 47.625
2 @ 96

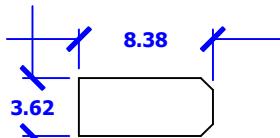

S8-10
2 @ 72"

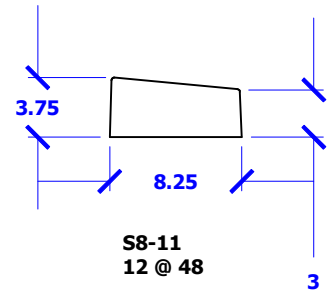

S8-11
12 @ 48

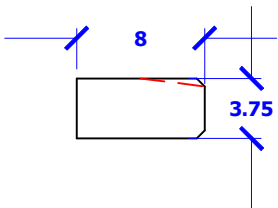

S8-12
1 at 64 lug ends
cypress

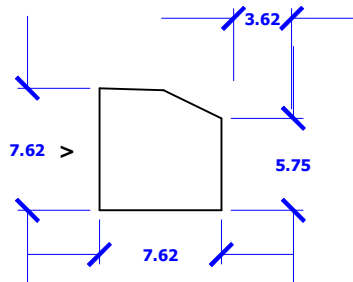

S8-13
1 @ 96
Desert Hills

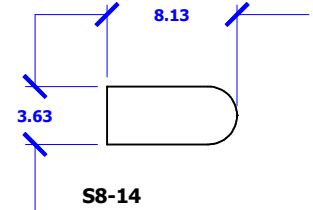

S8-14
8 @ 48
2 stretch corners
Chase Bank

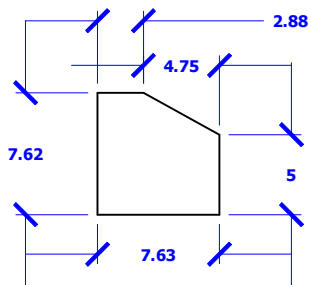

S8-15
1 at 101.25 left
1 at 101.25 right
BYU Cannon Center

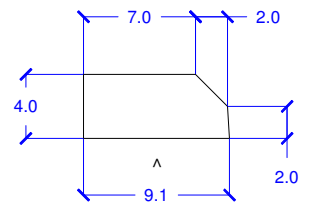

S9-1
5 @ 48"

SILLS SHEET 4a - LAST REVISION 4/21/07



882 N. Marshall Way
Layton, UT 84041
Ph. (801) 544-9054
Fax: (801) 544-9154

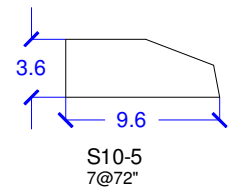
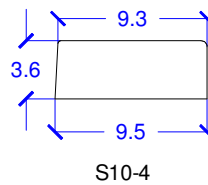
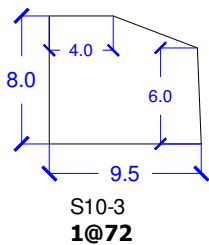
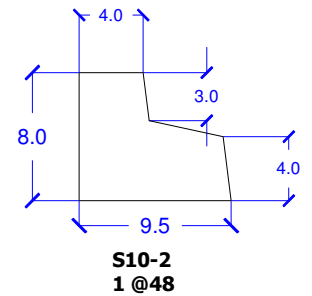
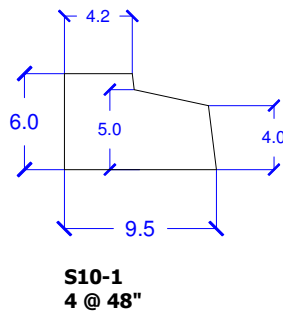
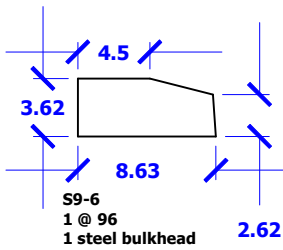
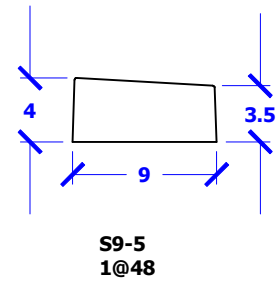
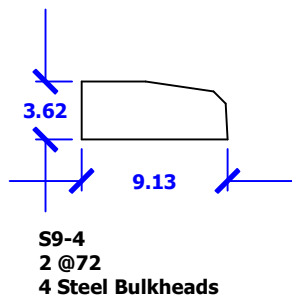
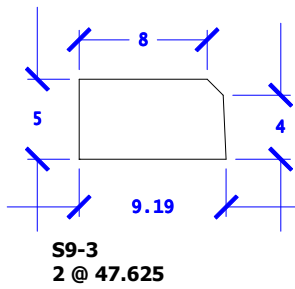
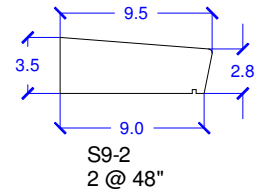

SILLS SHEET 5 - LAST REVISION 4/21/07



882 N. Marshall Way
Layton, UT 84041
Ph. (801) 544-9054
Fax: (801) 544-9154

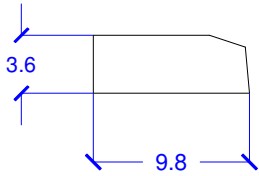

S10-6
1@72"

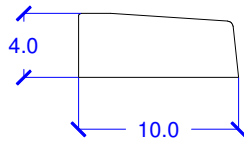

S10-7
1@ 48

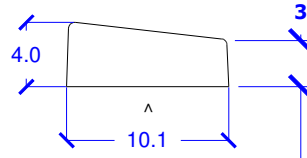

S10-8
1@48

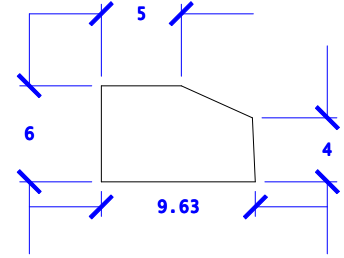

S10-9
1@96+bulkhead

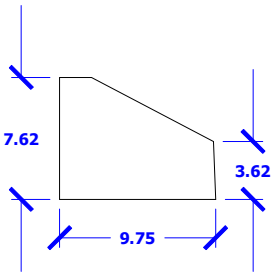

S10-10
1@47.625
1@72 rightfinend

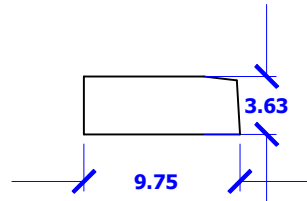

S10-11
1 at 96

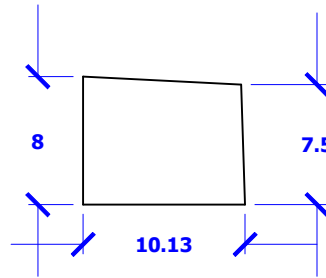

S10-12
1 at 48"
monache

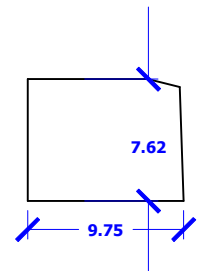

S10-13
1@96
Midway

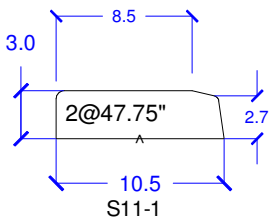

S11-1

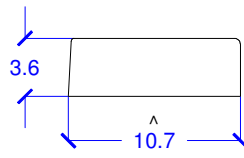

S11-2
1@47.625

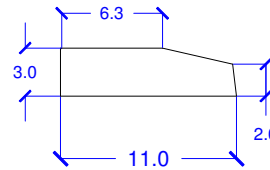

S11-3
6 @ 60

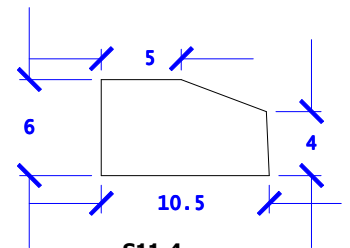

S11-4
1@ 31.625
1 leftfin
1 rightfin

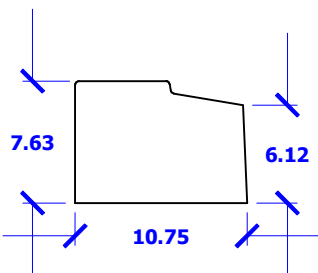

S11-5
1 @ 96"

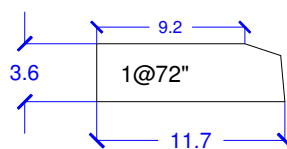

S12-1

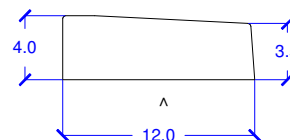

S12-2
1@48"

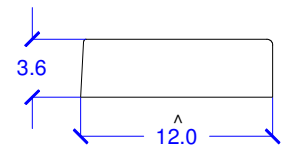

S12-3
1@47.625"

SILLS SHEET 6 - LAST REVISION 4/21/07



882 N. Marshall Way
Layton, UT 84041
Ph. (801) 544-9054
Fax: (801) 544-9154

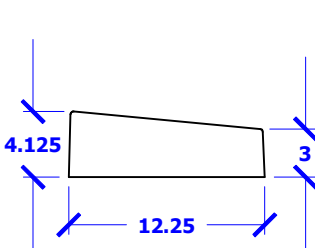

S12-4
6 @ 48

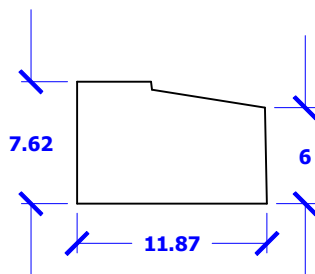

S12-5
1 @ 72

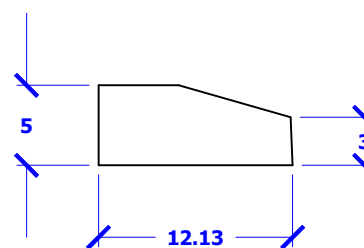

S12-6
3 @ 96

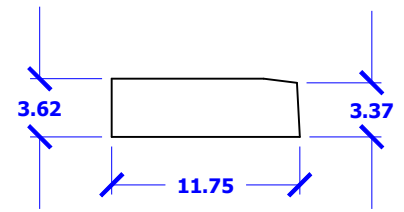

S12-7
2 @ 96
2 steel bulkheads

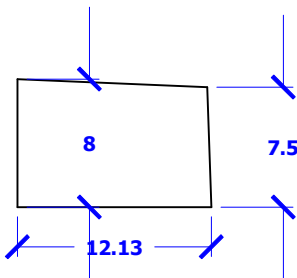

S12-8
3 at 48
Monache

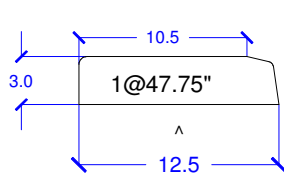

S13-1

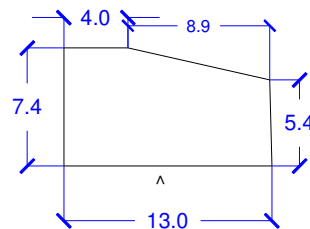

S13-2
1 @ 48

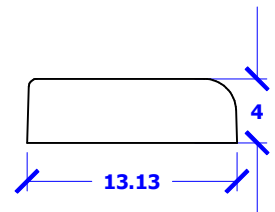

S13-3
3 at 48
1 corner 24x24

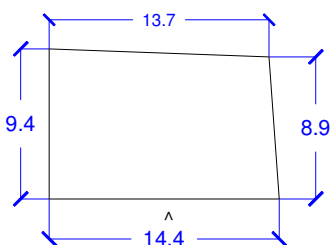

S14-1
1 @ 72"

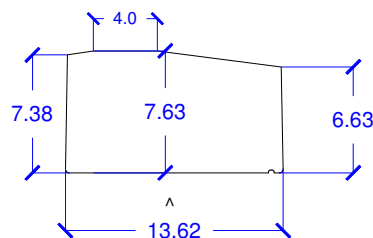

S14-2
1 or
3 @ 48

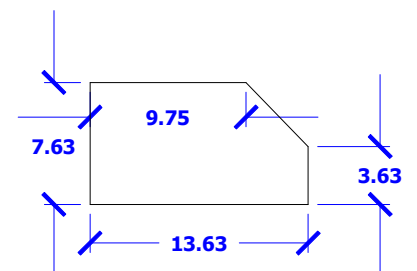

S14-3
1 @ 47.625"

SILLS SHEET 7 - LAST REVISION 4/21/07



882 N. Marshall Way
Layton, UT 84041
Ph. (801) 544-9054
Fax: (801) 544-9154

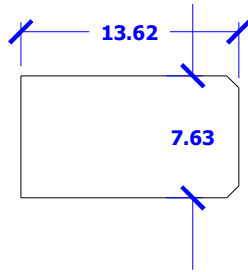

S14-4
1 @ 63.625"

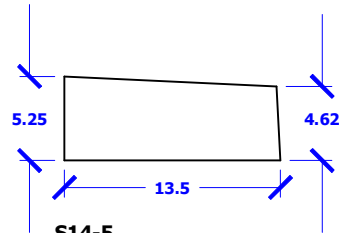

S14-5
5 at 72"
Meridian Condos
(Primary Children's)

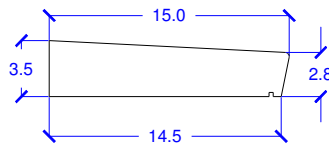

S15-1
1 @ 48"

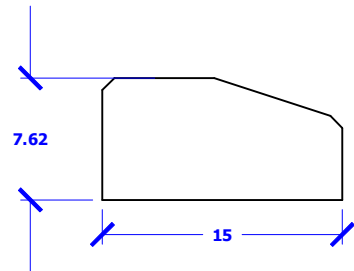

S15-2
1 @ 48
Desert Hills

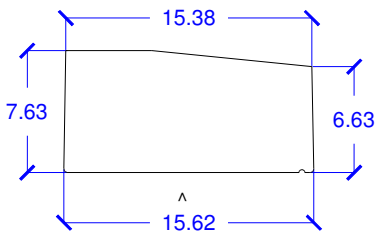

S16-1
1 @ 48"

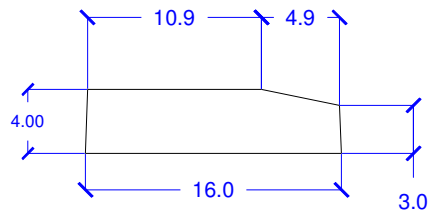

S16-2
2 @ 48"

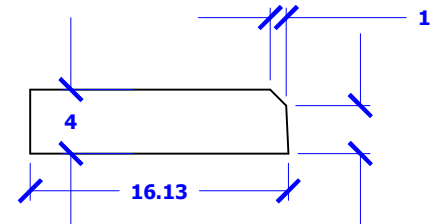

S16-3
2 @ 48

SILLS SHEET 8 - LAST REVISION 4/21/07



882 N. Marshall Way
Layton, UT 84041
Ph. (801) 544-9054
Fax: (801) 544-9154

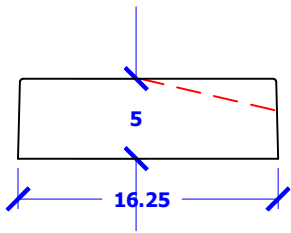

S16-4
2@95.625 lug ends

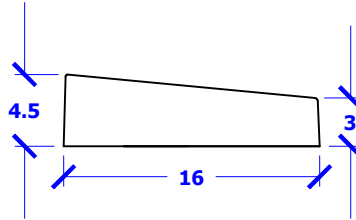

S16-5
2@48 2 steel bulkheads
G2Verizon

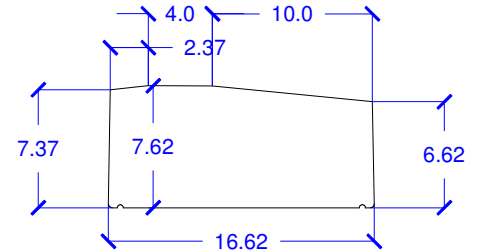

S17-1
2@48"

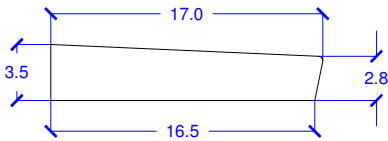

S17-2
1@48"

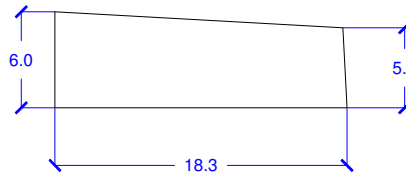

S18-1
1@36"

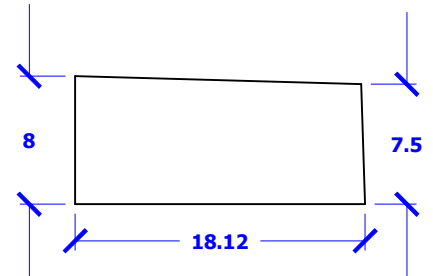

S18-2
2 at 48"
Monache

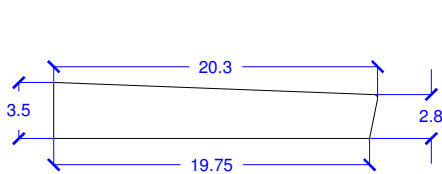

S20-1
1@48"

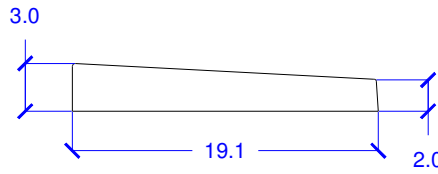

S19-1
2@24"

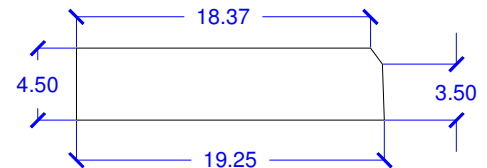

S19-2
2 @24"

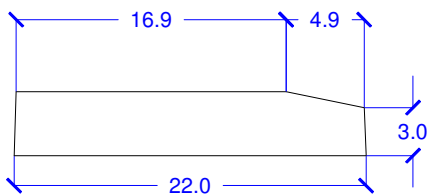

S22-1
2@24"

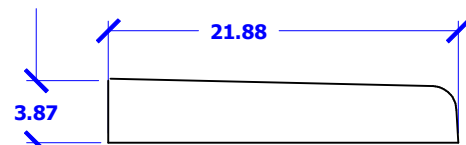

S22-2
2 at 47.63
1 double finished end
1 inside corner

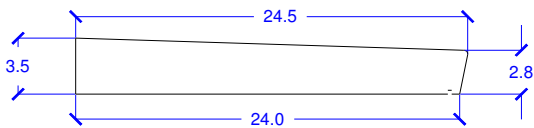

S24-1
1 @ 36"

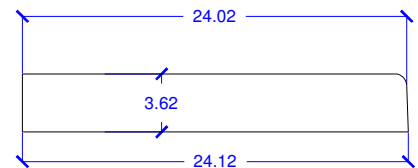

S24-2
1 @ 48"